

Robot Stand

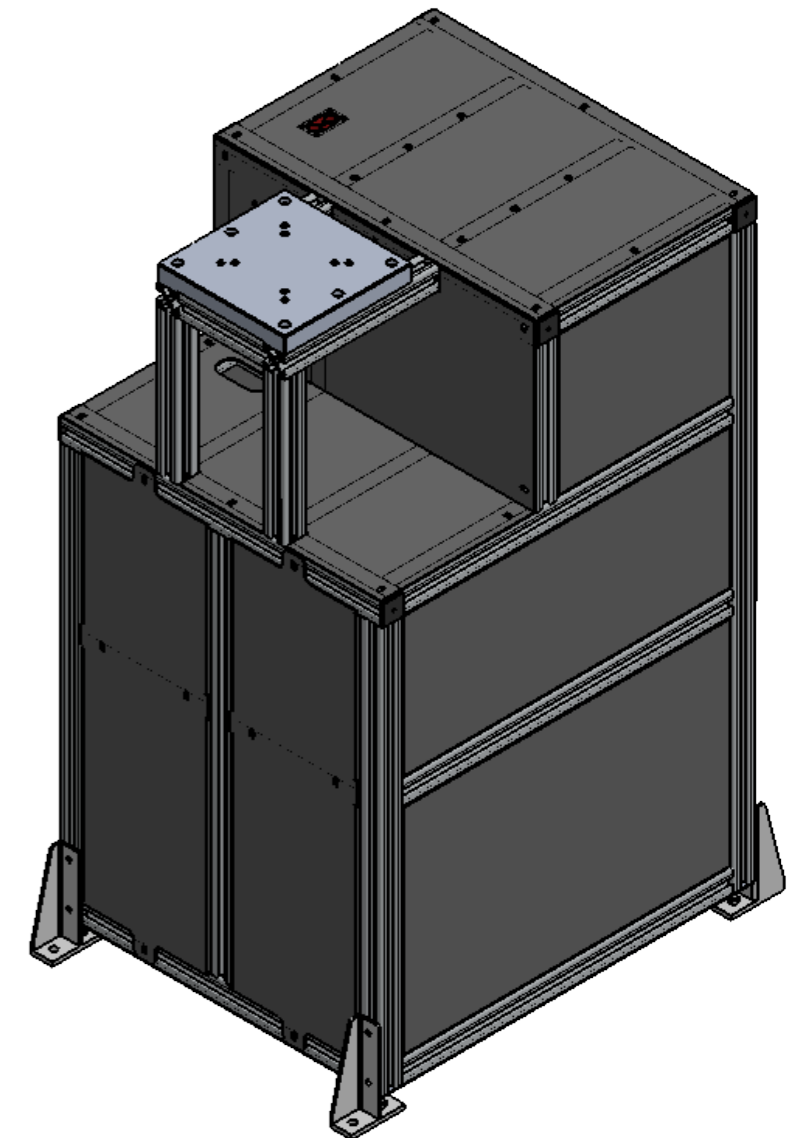
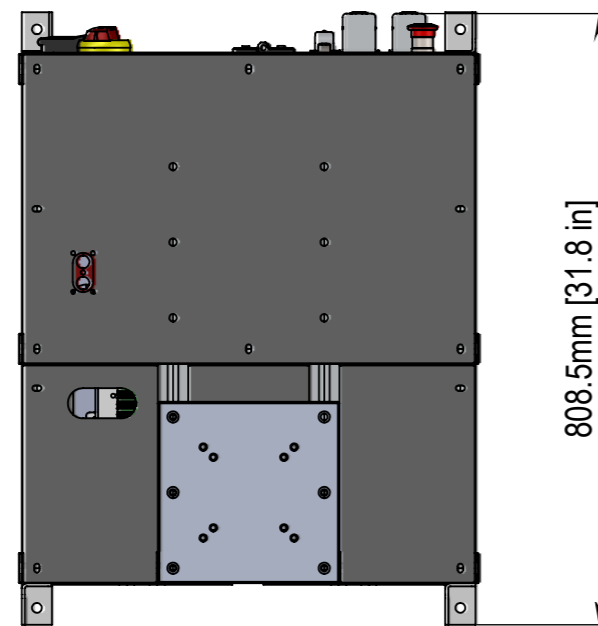
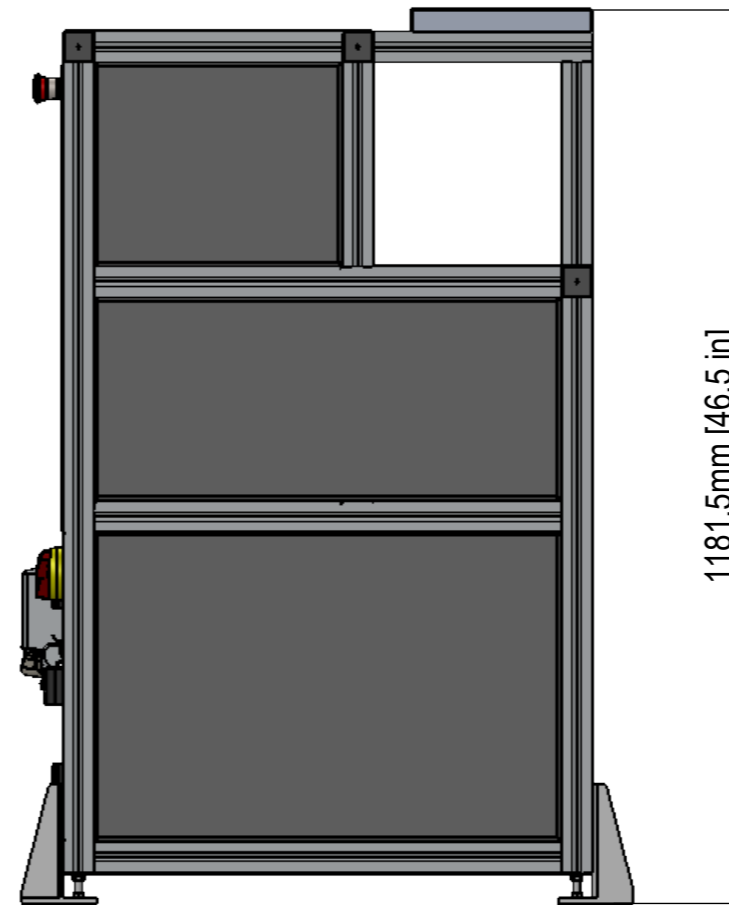
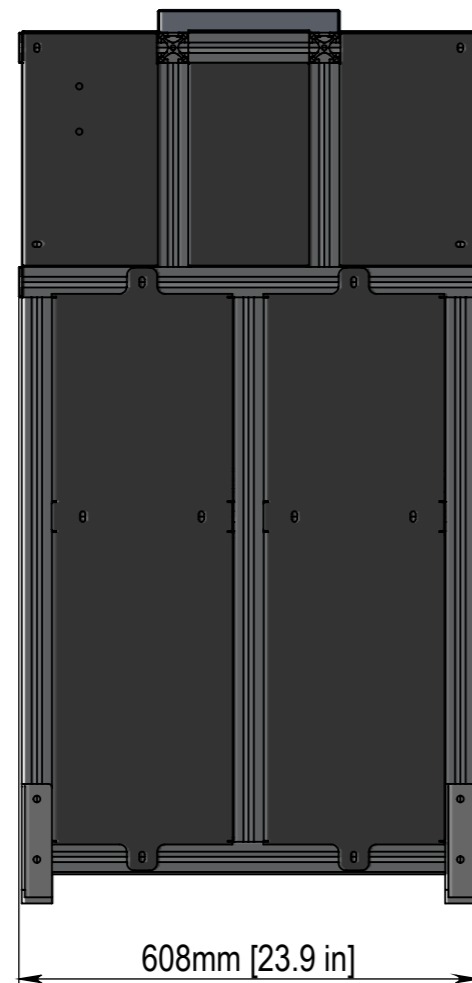

This drawing is a reference of the parts that are included in the 0UPT-077-100 series:

For further information, see the operating manual OM-0UPT-077-100-XX

Proprietary and Confidential The information contained in this drawing is the sole property of "ULTRAFLEX". Any reproduction in part or as a whole without the written permission of "ULTRAFLEX" is prohibited.	TOLERANCES (unless otherwise specified)		MATERIAL -		OID-0UPT-077-100-XX			
	LINEAR 0.5 - 6: ±0.1 >6 - 30: ±0.2 >30 - 120: ±0.3 >120 - 400: ±0.5 >400 - 1000: ±0.8	ANGULAR ±0.5°	FINISH -					
	Unspecified geometrical tolerances according to BS EN 22768 - 2, k		SURFACE FINISH Ra 3.2	FIRST ANGLE PROJECTION DIMENSIONS - mm		A3	OUTERLINE & INSTALLATION DRAWING	
					Revision: A21	Approximate weight 113543.63 g	Scale 1:50	Sheet 1 of 6

Robot UR5e

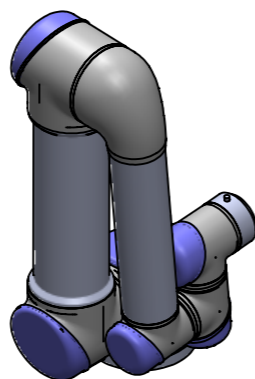
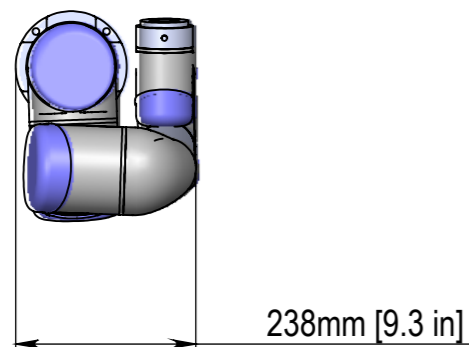
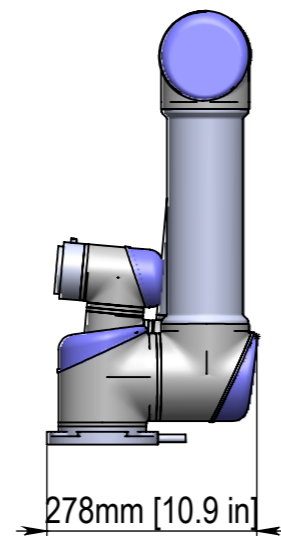
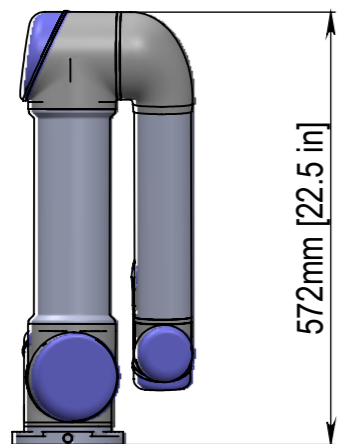

Robot UR10e

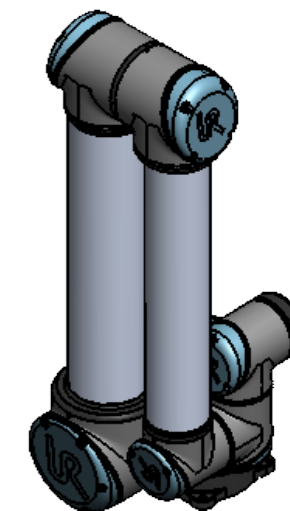
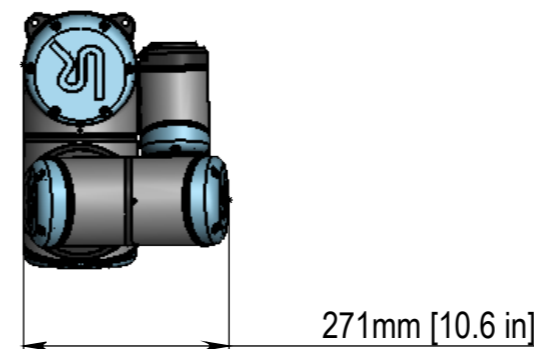
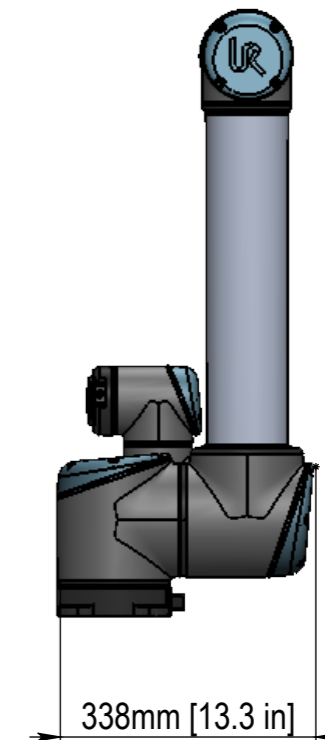
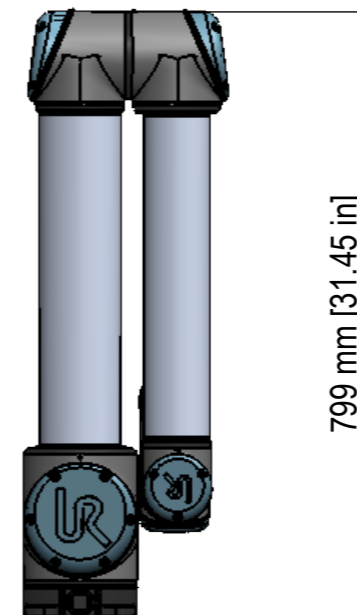

This drawing is a reference of the parts that are included in the OUPT-077-100 series:

For further information, see the operating manual OM-OUPT-077-100-XX

Proprietary and Confidential The information contained in this drawing is the sole property of "ULTRAFLEX". Any reproduction in part or as a whole without the written permission of "ULTRAFLEX" is prohibited.	TOLERANCES (unless otherwise specified)		MATERIAL -		OID-0UPT-077-100-XX			
	LINEAR 0.5 - 6: ±0.1 >6 - 30: ±0.2 >30 - 120: ±0.3 >120 - 400: ±0.5 >400 - 1000: ±0.8	ANGULAR ±0.5°	FINISH					
	Unspecified geometrical tolerances according to BS EN 22768 - 2, k		SURFACE FINISH Ra 3.2	FIRST ANGLE PROJECTION DIMENSIONS - mm		A3	OUTERLINE & INSTALLATION DRAWING	
					Revision: A00	Approximate weight 12000.00 g	Scale 1:50	Sheet 2 of 6

Robo Braze

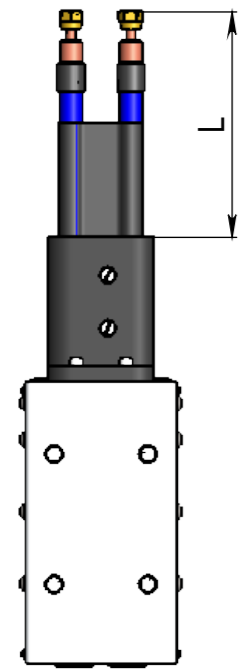
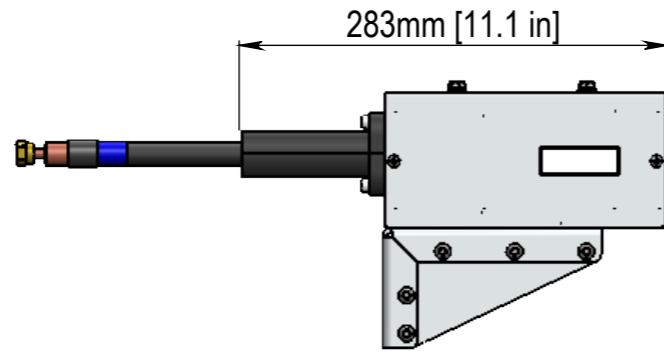
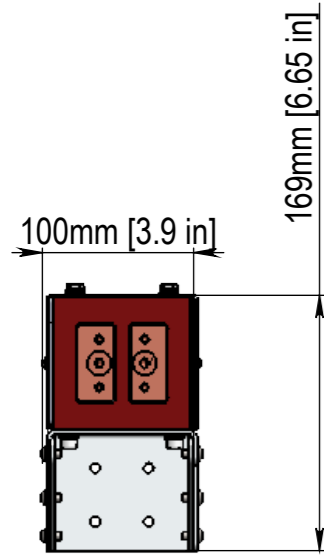

L = 3000mm [118.1 in]

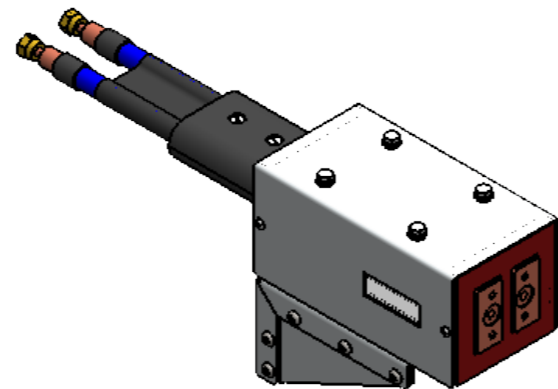

Robo Braze 90 degree

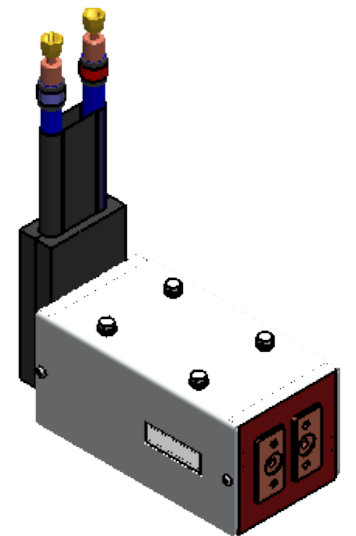
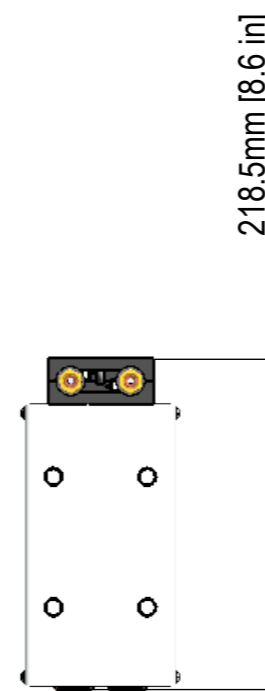
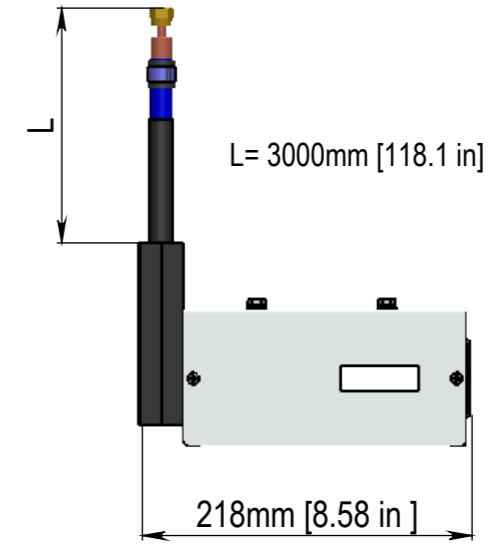
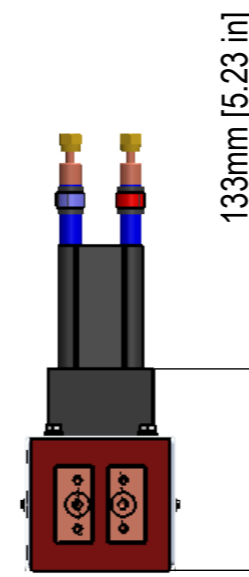

This drawing is a reference of the parts that are included in the 0UPT-077-100 series:

For further information, see the operating manual OM-0UPT-077-100-XX

Proprietary and Confidential The information contained in this drawing is the sole property of "ULTRAFLEX". Any reproduction in part or as a whole without the written permission of "ULTRAFLEX" is prohibited.	TOLERANCES (unless otherwise specified)		MATERIAL -		OID-0UPT-077-100-XX		
	LINEAR 0.5 - 6: ±0.1 >6 - 30: ±0.2 >30 - 120: ±0.3 >120 - 400: ±0.5 >400 - 1000: ±0.8	ANGULAR ±0.5°	FINISH -				
	Unspecified geometrical tolerances according to BS EN 22768 - 2, k		SURFACE FINISH Ra 3.2	FIRST ANGLE PROJECTION DIMENSIONS - mm		OUTERLINE & INSTALLATION DRAWING	
	A3				Revision: B00	Approximate weight 4424.65 g	Scale 1:50

1. Mounting of the stand

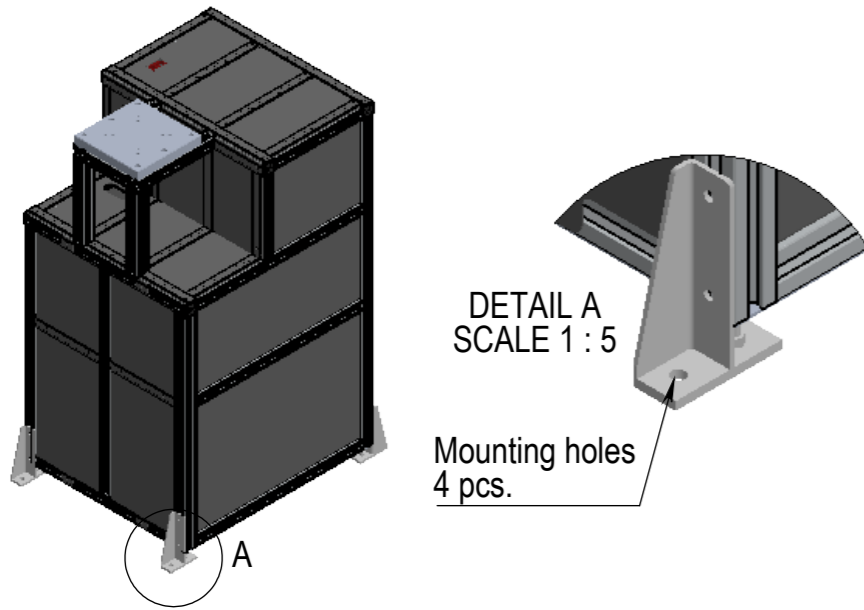

The stand is mounted:

- to the ground with anchor M12.
- other surface(frame or ext.) with bolt M12.

2.3 Connecting robot power cable

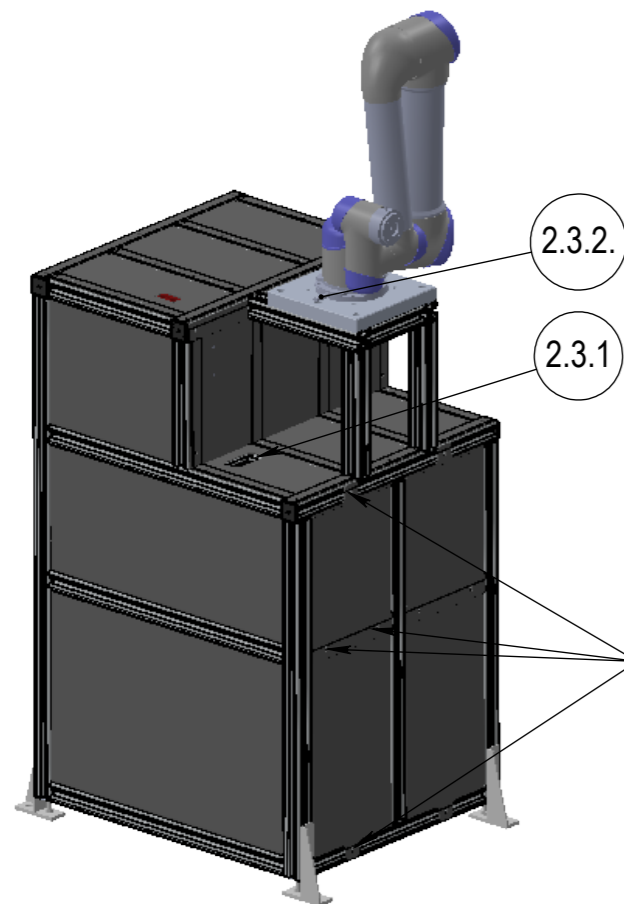

Step 1:
Removing the front left panel,
to gain access to the UR5 Controller.

Step 3:
Re-attach the removed front left panel.

2. Mounting of Robot.

2.1 Robot mounting plate can be mounted to the stand on two positions, depending on the client needs.

- 2.1.1 - On the frame balcony.
- 2.1.2 - On the top of the stand.

Mounting fasteners
(included in the package):

- 2.2.1 - Bolt DIN 912 M8x35. - 6pcs.
- 2.2.2 - Washer DIN 127 M8. - 6pcs.

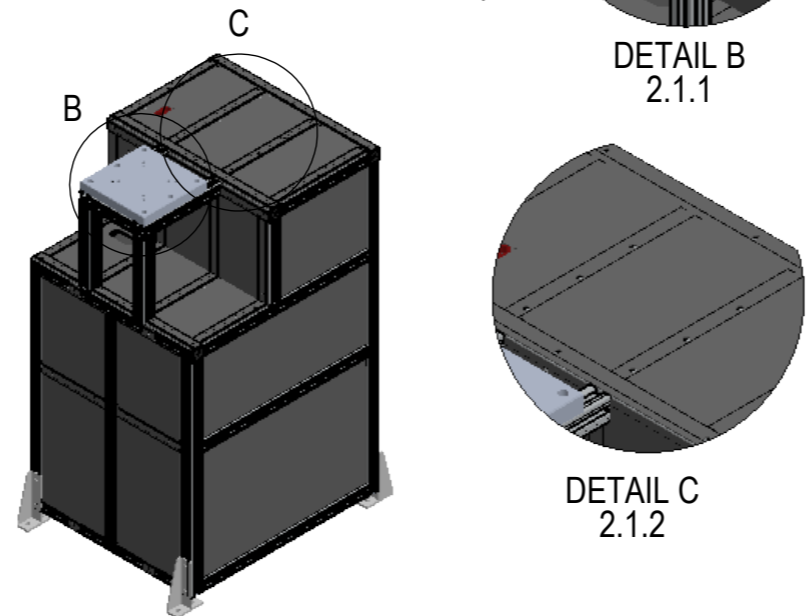

2.2 Mounting Robot UR5e/UR10e

The robot is mounted to the plate with fasteners(included in the package):

- 2.2.3 - Bolt DIN 912 M8x35. - 4pcs.(for UR10e - 6pcs.)

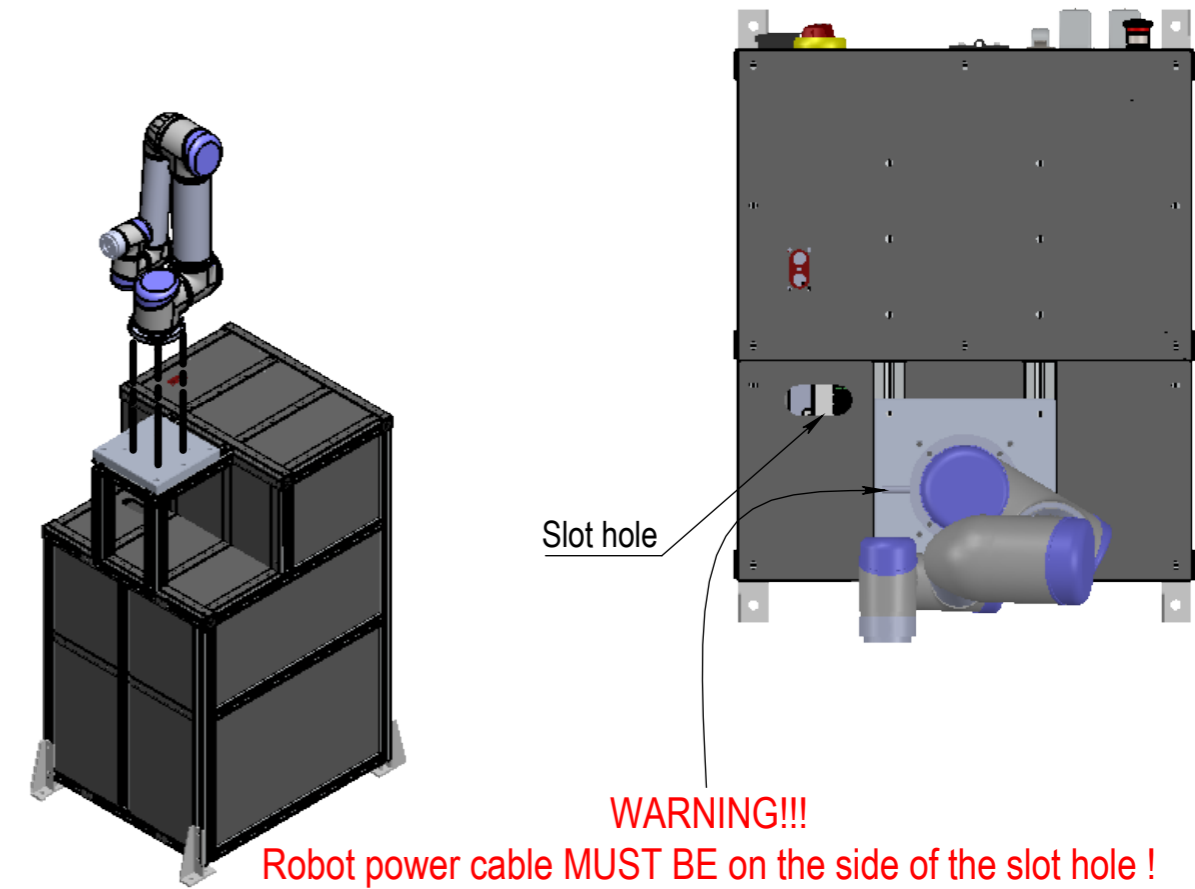

Step 2:

After removing the panel you can see the power cable of the robot that is connected to the UR5 controller on one end.

- 2.3.1.- This cable has to come out from the slot.
- 2.3.2.- Then connected to the robot.

<small>Proprietary and Confidential The information contained in this drawing is the sole property of "ULTRAFLEX". Any reproduction in part or as a whole without the written permission of "ULTRAFLEX" is prohibited.</small>	TOLERANCES (unless otherwise specified)		MATERIAL		OID-0UPT-077-100-XX		
	LINEAR 0.5 - 6: ±0.1 >6 - 30: ±0.2 >30 - 120: ±0.3 >120 - 400: ±0.5 >400 - 1000: ±0.8	ANGULAR ±0.5°	-				
Unspecified geometrical tolerances according to BS EN 22768 - 2, k		SURFACE FINISH Ra 3.2	FIRST ANGLE PROJECTION DIMENSIONS - mm		Robot stand & Robot Mounting		
		A3		Revision: A21	Approximate weight 113543.63 g	Scale 1:50	Sheet 4 of 6

3. Mounting Robot Braze / Robo Braze 90 degree.

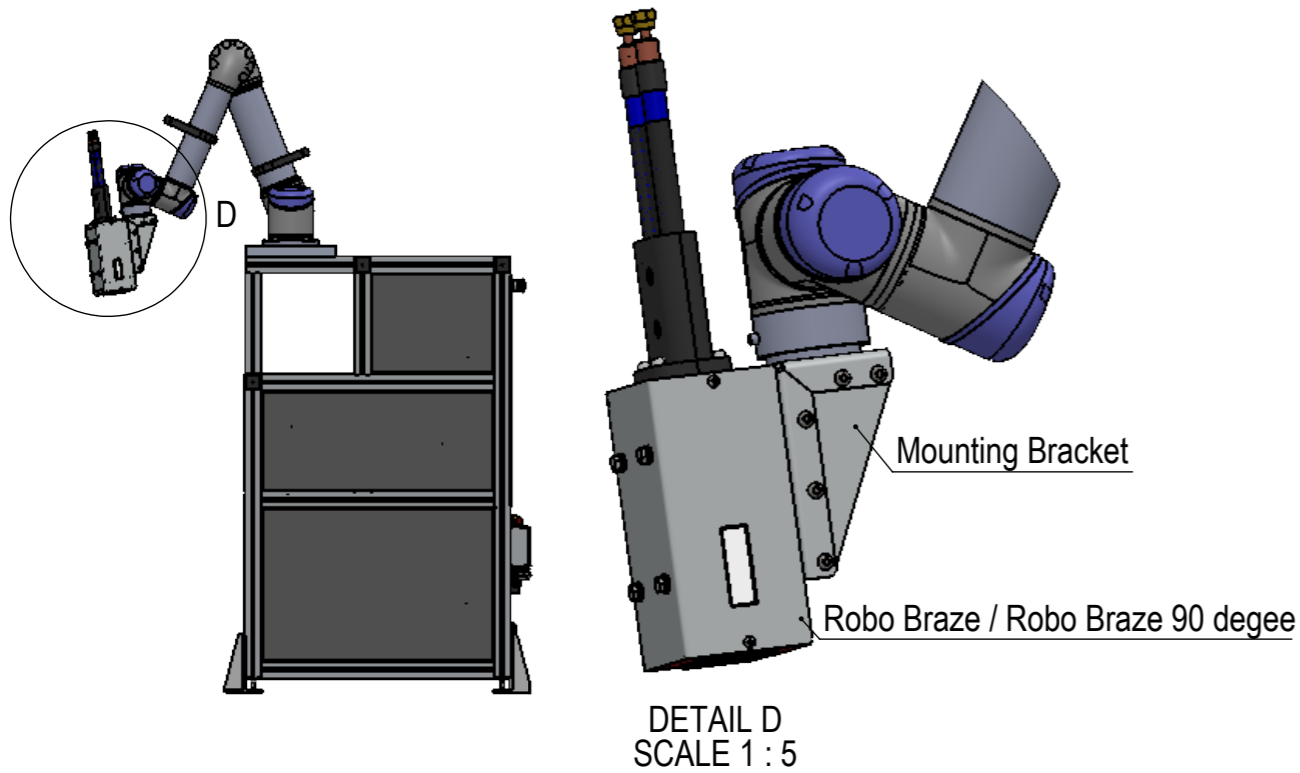

3.1 Attaching the Mounting Bracket to the robot with fasteners(included):

- 3.1.1 Washer DIN 125 M6. - 4pcs.
- 3.1.2 Washer DIN 127 M6. - 4pcs.
- 3.2.3 Bolt DIN912 M6x10. - 4pcs.

3.2 Attaching the Mounting Bracket to the Robo Braze / Robo Braze 90 degree with fasteners(included):

- 3.1.1 Washer DIN 125 M6. - 4pcs.
- 3.1.2 Washer DIN 127 M6. - 4pcs.
- 3.2.3 Bolt DIN912 M6x12. - 4pcs.

3.3 Attaching the RF cable to the heat station

Step2:
Removing the fasteners that hold the GPO3 plate,
so the RF cable can pass thru.

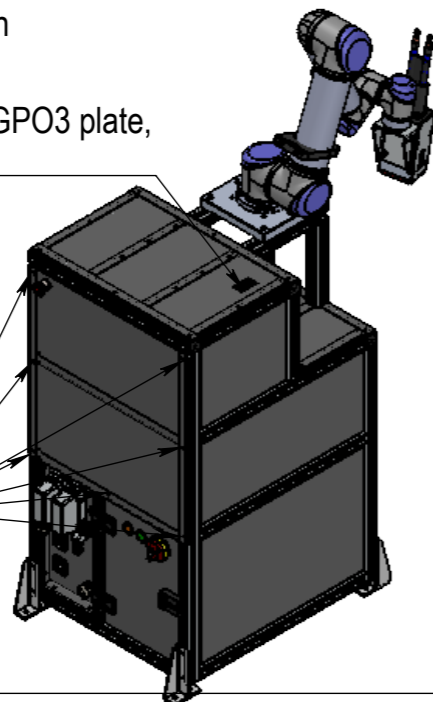

Step 1:
Removing the back panel and then
the right side panel from the inside
to gain access to the Heat Station.

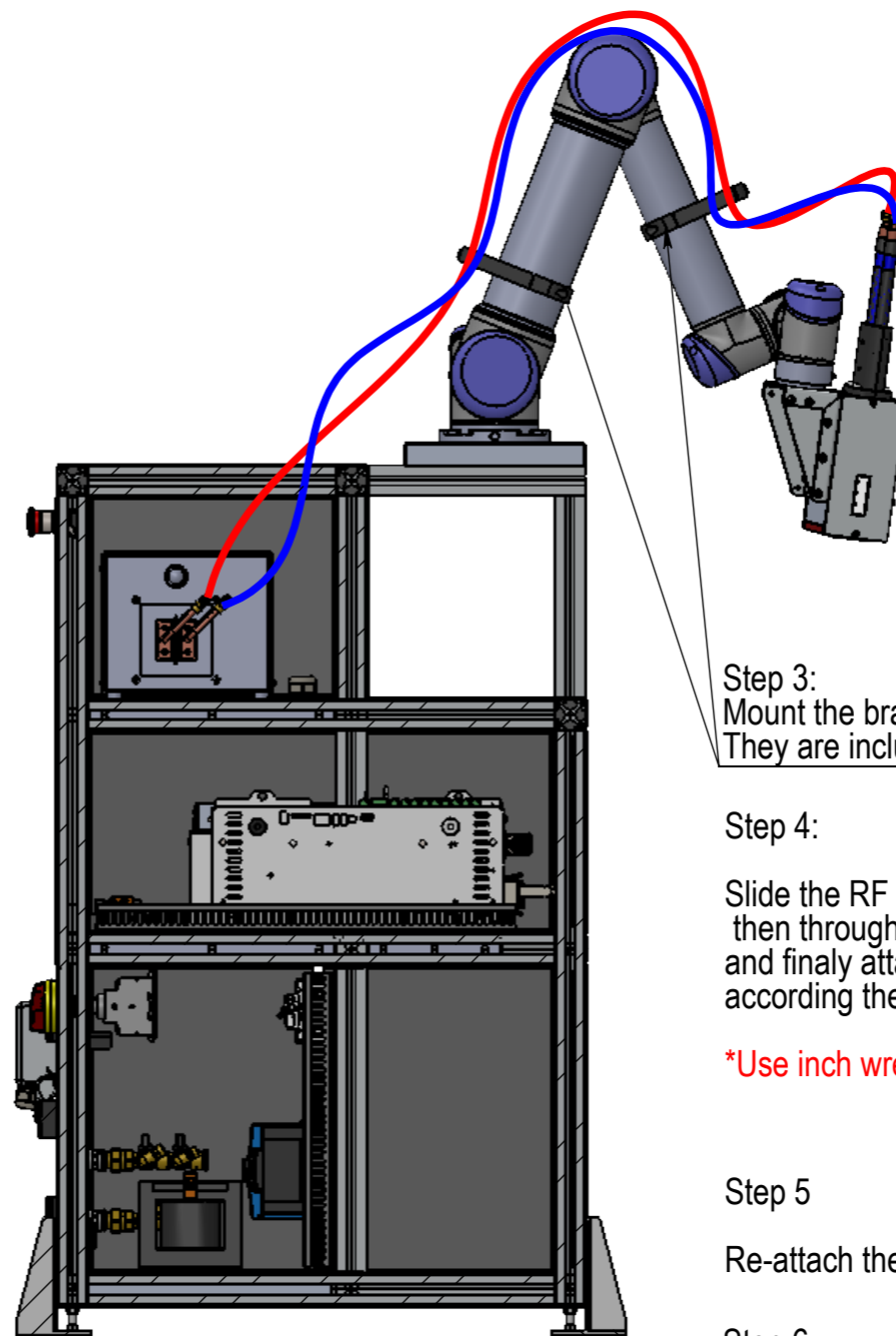

Step 3:
Mount the brackets for the RF cable.
They are included in the package

Step 4:

Slide the RF cable through the brackets,
then through the hole with the removed GPO3
and finally attach the RF cable to the heat station
according the labels that are on the cable and on the heat station.

***Use inch wrench keys 7/16 and 9/16. to tighten the nuts.**

Step 5

Re-attach the GPO3 brackets with the fasteners.

Step 6:

Re-attach the removed back the right side panel.

Proprietary and Confidential The information contained in this drawing is the sole property of "ULTRAFLEX". Any reproduction in part or as a whole without the written permission of "ULTRAFLEX" is prohibited.	TOLERANCES (unless otherwise specified)		MATERIAL -		OID-0UPT-077-100-XX			
	LINEAR 0.5 - 6: ±0.1 >6 - 30: ±0.2 >30 - 120: ±0.3 >120 - 400: ±0.5 >400 - 1000: ±0.8	ANGULAR ±0.5°	FINISH					
	Unspecified geometrical tolerances according to BS EN 22768 - 2, k		SURFACE FINISH Ra 3.2	FIRST ANGLE PROJECTION DIMENSIONS - mm		A3	Robo Braze Mounting	
					Revision: A21	Approximate weight 130641.05 g	Scale 1:50	Sheet 5 of 6

4. Water connection.

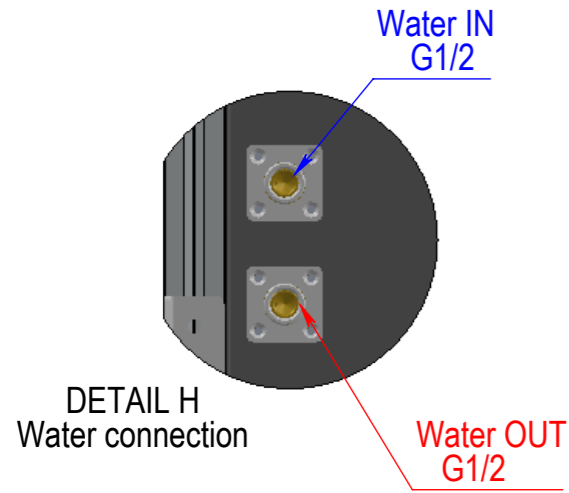

WARNING:
Please, after connecting and turning ON the water to the machine, wait for a couple of minutes and check for leakage before proceeding with the next step!

5. Communication connections.

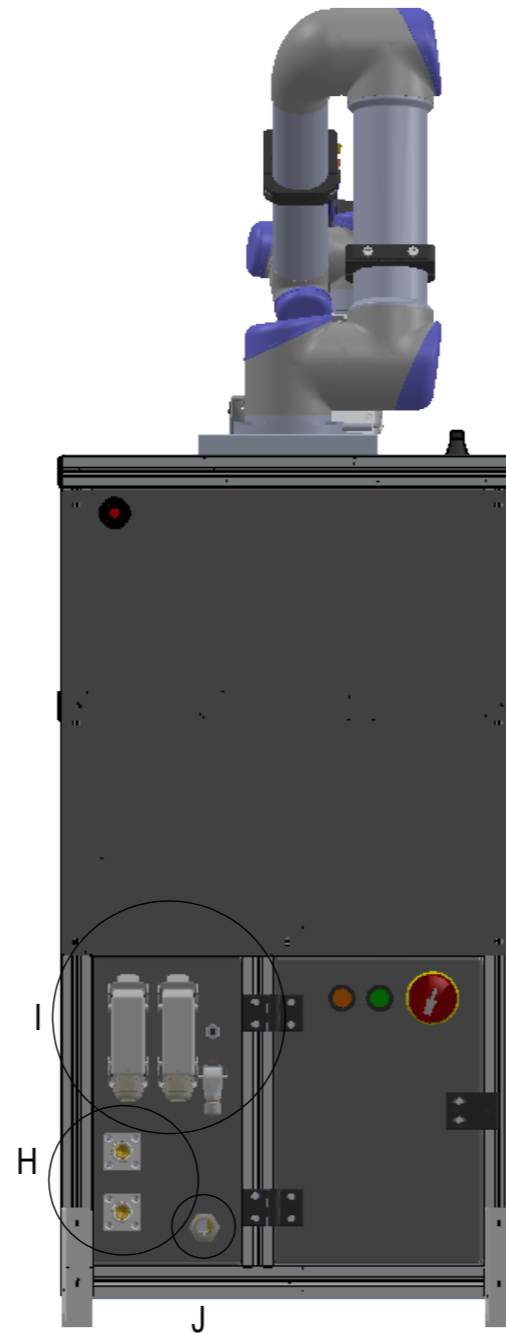
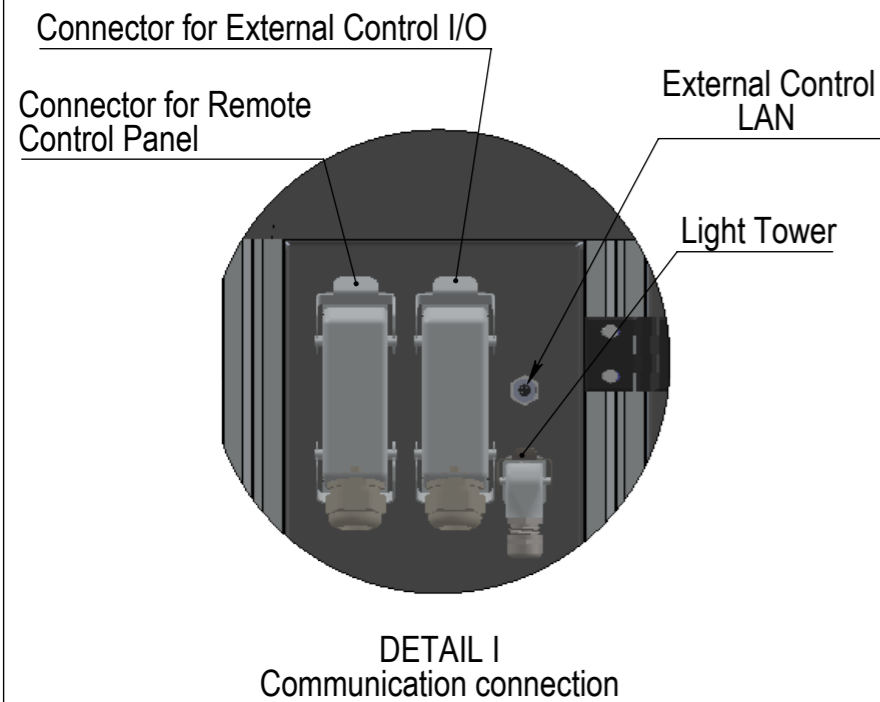

6. Power connection



The power cable go through the PG and then is connected to the terminals in this order:

Line 1 - Black;
Line 2 - Brown;
Line 3 - Gray;

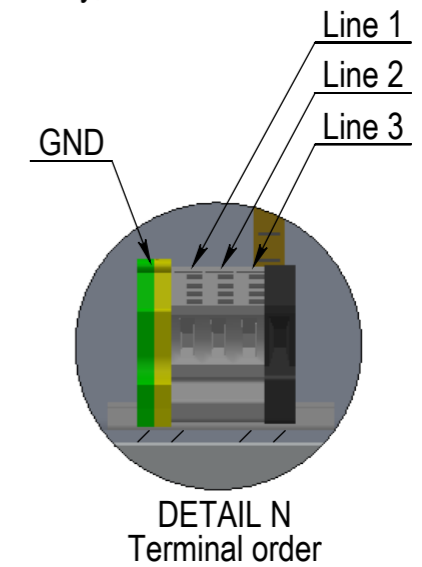

<small>Proprietary and Confidential. The information contained in this drawing is the sole property of "ULTRAFLEX". Any reproduction in part or as a whole without the written permission of "ULTRAFLEX" is prohibited.</small>	TOLERANCES (unless otherwise specified)		MATERIAL -		OID-0UPT-077-100-XX			
	LINEAR 0.5 - 6: ±0.1 >6 - 30: ±0.2 >30 - 120: ±0.3 >120 - 400: ±0.5 >400 - 1000: ±0.8	ANGULAR ±0.5°	FINISH					
	Unspecified geometrical tolerances according to BS EN 22768 - 2, k		SURFACE FINISH Ra 3.2	FIRST ANGLE PROJECTION DIMENSIONS - mm	A3		Water & Electrical Connection	
					Revision: A21	Approximate weight 133181.58 g	Scale 1:50	Sheet 6 of 6